

Arbors

Grundaufnahmen

Державки

Stożki bazowe

Attacchi base

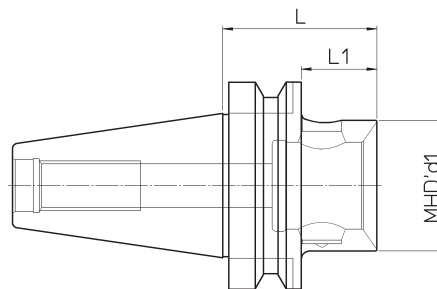
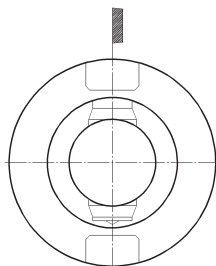

BT	REF.	CODE	MHD' d ₁	L	L ₁	kg
30	MAS403 BT30 MHD'32.32	41 6 32 01 030 30	32	32	10.5	0.5
	MAS403 BT30 MHD'40.35.5	41 6 40 01 030 30	40	35.5	14	0.6
	MAS403 BT30 MHD'50.60	41 6 50 01 030 30	50	60	-	0.7
MAS403 BT35 MHD'50.60	41 6 50 01 035 30	36			0.8	
40	MAS403 BT40 MHD'40.45	41 6 40 01 040 30	40	45	18	0.6
	MAS403 BT40 MHD'50.38.5	41 6 50 01 040 39	50	38.5	11.5	0.8
	MAS403 BT40 MHD'50.48	41 6 50 01 040 30		48	21	0.9
	MAS403 BT40 MHD'50.56	41 6 50 01 040 80		56	29	1.1
	MAS403 BT40 MHD'63.66	41 6 63 01 040 30	63	66	-	1.2
45	MAS403 BT45 MHD'50.62	41 6 50 01 045 30	50	62	29	1.7
	MAS403 BT45 MHD'63.70	41 6 63 01 045 30	63	70	37	2.3
	MAS403 BT45 MHD'80.70	41 6 80 01 045 30	80			2.7
50	MAS403 BT50 MHD'50.66	41 6 50 01 050 30	50	66	28	3.3
	MAS403 BT50 MHD'63.50	41 6 63 01 050 39	63	50	12	3.4
	MAS403 BT50 MHD'63.75	41 6 63 01 050 30		75	37	3.7
	MAS403 BT50 MHD'80.50	41 6 80 01 050 39	80	50	12	3.8
	MAS403 BT50 MHD'80.75	41 6 80 01 050 30		75	37	4
	MAS403 BT50 MHD'110.140	41 6 91 01 050 30	110	140	-	6.8
	MAS403 BT50 MHD'140.150	41 6 94 01 050 30	140	150	-	9.2
60	MAS403 BT60 MHD'110.110	41 6 91 01 060 30	110	110	63	11.5
	MAS403 BT60 MHD'110.200	41 6 91 01 060 38		200	152	18.1
	MAS403 BT60 MHD'140.100	41 6 94 01 060 30	140	100	52	12.9
	MAS403 BT60 MHD'140.250	41 6 94 01 060 38		250	202	30.1

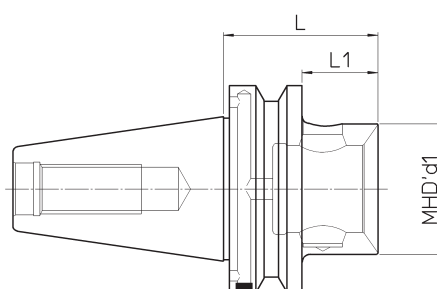
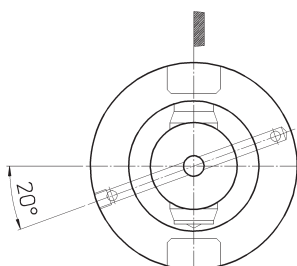

BT	REF.	CODE	MHD' d ₁	L	L ₁	kg
40	MAS403 BT40B MHD'50.48	41 6 50 01 040 31	50	48	21	0.9
	MAS403 BT40B MHD'63.66	41 6 63 01 040 31	63	66	-	1.2
50	MAS403 BT50B MHD'50.66	41 6 50 01 050 31	50	66	28	3.5
	MAS403 BT50B MHD'63.75	41 6 63 01 050 31	63	75	37	3.7
	MAS403 BT50B MHD'80.75	41 6 80 01 050 31	80			4

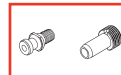

MAS 403 BT



Arbors

Grundaufnahmen

Державки

Stożki bazowe

Attacchi base

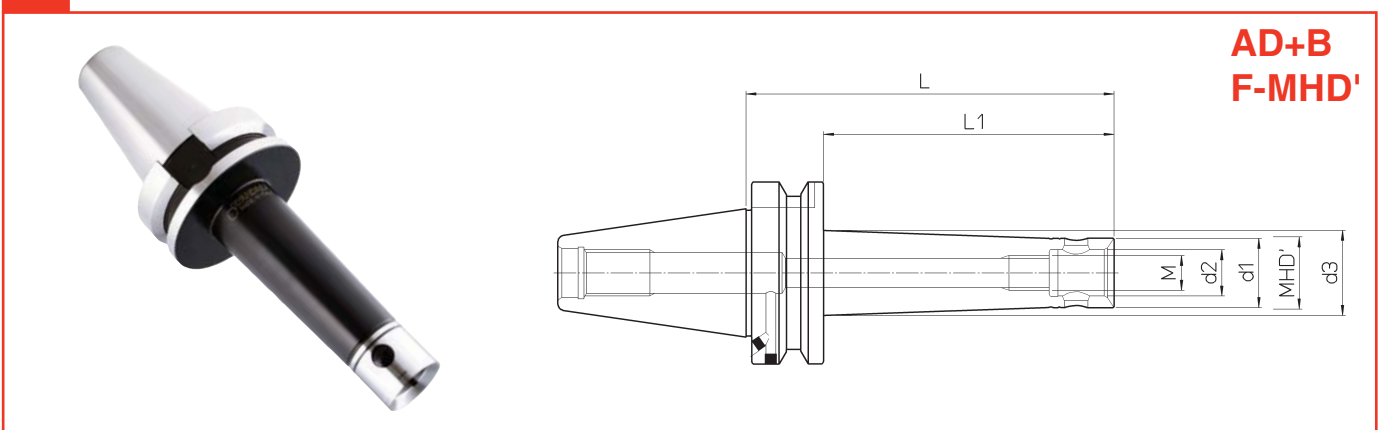

**AD+B
F-MHD'**

BT	REF.	CODE	MHD'	d ₁	d ₂	d ₃	M	L	L ₁	kg
40	MAS403 BT40-AD+B F-MHD'16.45	41 6 16 04 140 31	16	15.5	10	–	M 8	45	18	0.8
	MAS403 BT40-AD+B F-MHD'16.63	41 6 16 06 140 31				17		63	36	0.9
	MAS403 BT40-AD+B F-MHD'16.100	41 6 16 10 140 31				19.5		100	73	1
	MAS403 BT40-AD+B F-MHD'20.50	41 6 20 05 140 31	20	19.5	13	–	M 10	50	23	0.9
	MAS403 BT40-AD+B F-MHD'20.80	41 6 20 08 140 31				22		80	53	1
	MAS403 BT40-AD+B F-MHD'20.125	41 6 20 12 140 31				25		125	98	1.1
	MAS403 BT40-AD+B F-MHD'25.50	41 6 25 05 140 31	25	24	16	–	M 12	50	23	1
	MAS403 BT40-AD+B F-MHD'25.80	41 6 25 08 140 31				26.5		80	53	1.1
	MAS403 BT40-AD+B F-MHD'25.125	41 6 25 12 140 31				29.5		125	98	1.2
	MAS403 BT40-AD+B F-MHD'32.50	41 6 32 05 140 31	32	31	20	–	M 16	50	23	1.1
	MAS403 BT40-AD+B F-MHD'32.80	41 6 32 08 140 31				33		80	53	1.2
	MAS403 BT40-AD+B F-MHD'32.125	41 6 32 12 140 31				36		125	98	1.4



67

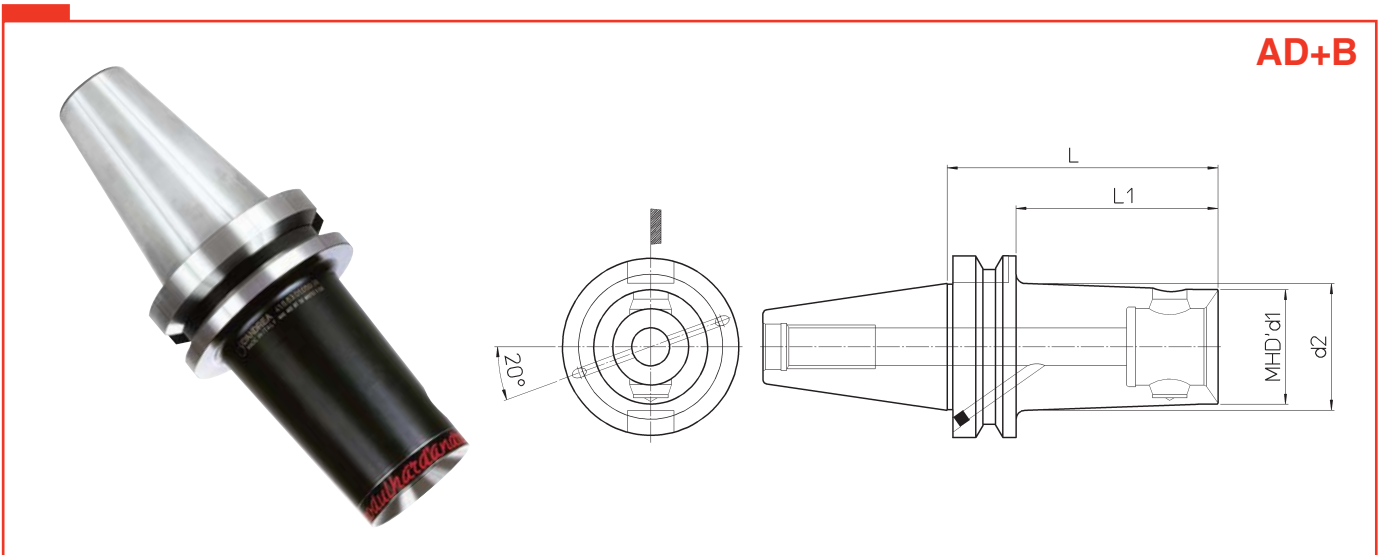

AD+B

BT	REF.	CODE	MHD' d ₁	d ₂	L	L ₁	kg
40	MAS403 BT40-AD+B MHD'40.120	41 6 40 01 040 38	40	44.5	120	93	0.9
	MAS403 BT40-AD+B MHD'50.120	41 6 50 01 040 38	50	–			1.9
50	MAS403 BT50-AD+B MHD'50.120	41 6 50 01 050 38	50	60	150	112	4.2
	MAS403 BT50-AD+B MHD'63.150	41 6 63 01 050 38	63	70			5.8
	MAS403 BT50-AD+B MHD'80.180	41 6 80 01 050 38	80	–			180

p. 228

p. 271

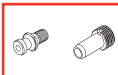

UNI
HSK DIN
MAS-BT