

ER

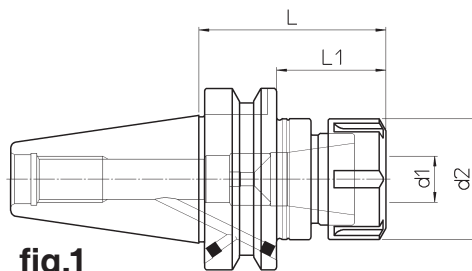

fig.1

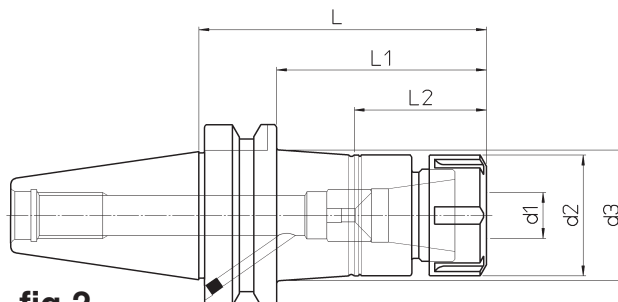

fig.2

Supplied without collets and clamping wrenches

Ohne Spannzangen und Spannschlüssel.

Поставляется без цанг и зажимного ключа.

Nie zawiera tulejek rozprężnych i kluczy do nakrętek

Pinze elastiche e chiavi di serraggio escluse

BT	REF.	CODE	TYPE	d ₁	d ₂	d ₃	L	L ₁	L ₂	kg	fig.
40	MAS403 BT40-AD+B ER16.60	71MBT-B40ER1606	ER 16 M	0.5 ~ 10	22	-	60	33	-	1	1
	MAS403 BT40-AD+B ER16.100	71MBT-B40ER1610				28	100	73	41	1.1	2
	MAS403 BT40-AD+B ER16.160	71MBT-B40ER1616				36.5	160	133		2.1	
	MAS403 BT40-AD+B ER25.65	71MBT-B40ER2506	ER 25	1 ~ 16	42	-	65	38	-	1.2	1
	MAS403 BT40-AD+B ER25.100	71MBT-B40ER2510				45.5	100	73	46	1.7	2
	MAS403 BT40-AD+B ER25.160	71MBT-B40ER2516				49.5	160	133		2.2	
	MAS403 BT40-AD+B ER32.70	71MBT-B40ER3207	ER 32	2 ~ 20	50	-	70	43	-	1.3	1
	MAS403 BT40-AD+B ER32.110	71MBT-B40ER3211					110	83		1.8	
	MAS403 BT40-AD+B ER32.160	71MBT-B40ER3216					160	133		2.8	
	MAS403 BT40-AD+B ER40.80	71MBT-B40ER4008	ER 40	3 ~ 26	63	-	80	53	-	1.4	
	MAS403 BT40-AD+B ER40.120	71MBT-B40ER4012					120	93		2.4	
	MAS403 BT40-AD+B ER40.160	71MBT-B40ER4016					160	133		3.4	

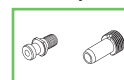
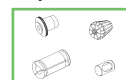

ER

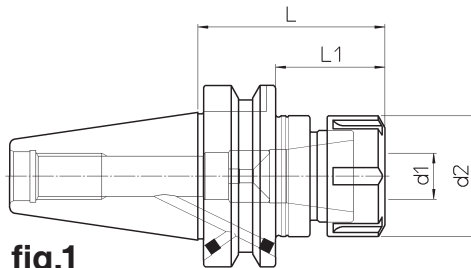

fig.1

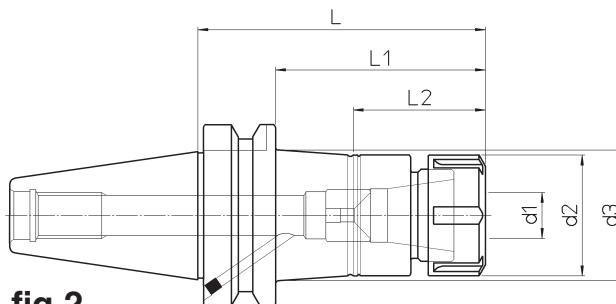

fig.2

Supplied without collets and clamping wrenches

Ohne Spannzangen und Spannschlüssel.

Поставляется без цанг и зажимного ключа.

Nie zawiera tulejek rozprężnych i kluczy do nakrętek

Pinze elastiche e chiavi di serraggio escluse

BT	REF.	CODE	TYPE	d ₁	d ₂	d ₃	L	L ₁	L ₂	kg	fig.
50	MAS403 BT50-AD+B ER16.100	71MBT-B50ER1610	ER 16 M	0.5 ~ 10	22	26.5	100	62	41	3.6	2
	MAS403 BT50-AD+B ER16.160	71MBT-B50ER1616				31	160	122		4.3	
	MAS403 BT50-AD+B ER25.75	71MBT-B50ER2507	ER 25	1 ~ 16	42	—	75	37	—	3.5	1
	MAS403 BT50-AD+B ER25.110	71MBT-B50ER2511				45.5	110	72	46	3.8	2
	MAS403 BT50-AD+B ER25.160	71MBT-B50ER2516				48.5	160	122		4.6	
	MAS403 BT50-AD+B ER32.80	71MBT-B50ER3208	ER 32	2 ~ 20	50	—	80	42	—	3.9	1
	MAS403 BT50-AD+B ER32.110	71MBT-B50ER3211				52.5	110	72	52	4.4	2
	MAS403 BT50-AD+B ER32.160	71MBT-B50ER3216				56	160	122		5	
	MAS403 BT50-AD+B ER40.100	71MBT-B50ER4010	ER 40	3 ~ 26	63	—	100	62	—	4.8	1
	MAS403 BT50-AD+B ER40.160	71MBT-B50ER4016				68.5	160	122	55	5.3	2

p. 228

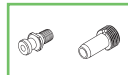

p. 230-233

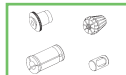

p. 240



p. 271



Weldon
toolholder

Werkzeugaufnahme
für Weldon

Патроны для инструмента с
креплением Weldon

Wyjście pod Weldon

Portautensile
Weldon

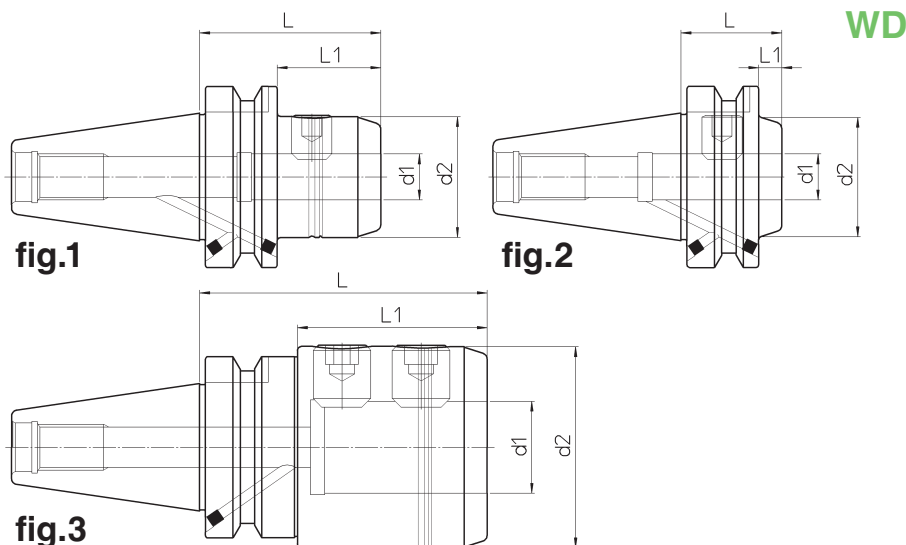

BT	REF.	CODE	d ₁ H5	d ₂	L	L ₁	kg	fig.
40	MAS403 BT40-AD+B WD06.50	71MBT-B40WD0605	6	23	50	23	0.8	1
	MAS403 BT40-AD+B WD06.110	71MBT-B40WD0611			110	83	0.9	
	MAS403 BT40-AD+B WD06.160	71MBT-B40WD0616			160	133	1.1	
	MAS403 BT40-AD+B WD08.50	71MBT-B40WD0805	8	26	50	23	0.9	
	MAS403 BT40-AD+B WD08.110	71MBT-B40WD0811			110	83	1.1	
	MAS403 BT40-AD+B WD08.160	71MBT-B40WD0816			160	133	1.3	
	MAS403 BT40-AD+B WD10.56	71MBT-B40WD1005	10	30	56	29	1	
	MAS403 BT40-AD+B WD10.110	71MBT-B40WD1011			110	83	1.2	
	MAS403 BT40-AD+B WD10.160	71MBT-B40WD1016			160	133	1.5	
	MAS403 BT40-AD+B WD12.35	71MBT-B40WD1203	12	34	35	8	0.9	2
	MAS403 BT40-AD+B WD12.56	71MBT-B40WD1205			56	29	1.1	1
	MAS403 BT40-AD+B WD12.110	71MBT-B40WD1211			110	83	1.4	
	MAS403 BT40-AD+B WD12.160	71MBT-B40WD1216			160	133	1.7	
	MAS403 BT40-AD+B WD14.56	71MBT-B40WD1405	14	38	56	29	1.2	1
	MAS403 BT40-AD+B WD14.110	71MBT-B40WD1411			110	83	1.6	
	MAS403 BT40-AD+B WD16.35	71MBT-B40WD1603	16	42	35	8	1	2
	MAS403 BT40-AD+B WD16.63	71MBT-B40WD1606			63	36	1.3	1
	MAS403 BT40-AD+B WD16.110	71MBT-B40WD1611			110	83	1.7	
	MAS403 BT40-AD+B WD16.160	71MBT-B40WD1616			160	133	2.2	
	MAS403 BT40-AD+B WD18.63	71MBT-B40WD1806	18	46	63	36	1.4	1
	MAS403 BT40-AD+B WD18.110	71MBT-B40WD1811			110	83	1.9	
	MAS403 BT40-AD+B WD20.35	71MBT-B40WD2003	20	50	35	8	1.1	2
	MAS403 BT40-AD+B WD20.63	71MBT-B40WD2006			63	36	1.5	1
	MAS403 BT40-AD+B WD20.110	71MBT-B40WD2011			110	83	2.1	
	MAS403 BT40-AD+B WD20.160	71MBT-B40WD2016			160	133	2.6	
	MAS403 BT40-AD+B WD25.35	71MBT-B40WD2503	25	63	35	8	1	2
	MAS403 BT40-AD+B WD25.100	71MBT-B40WD2510			100	73	2	
	MAS403 BT40-AD+B WD25.160	71MBT-B40WD2516			160	133	3.2	
MAS403 BT40-AD+B WD32.100	71MBT-B40WD3210	32	70	100	67	2.5	3	
MAS403 BT40-AD+B WD32.160	71MBT-B40WD3216			160	127	3.9		

p. 271

p. 240

p. 228

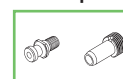

Weldon
toolholder

Werkzeugaufnahme
für Weldon

Патроны для инструмента с
креплением Weldon

Wyjście pod Weldon

Portautensile
Weldon

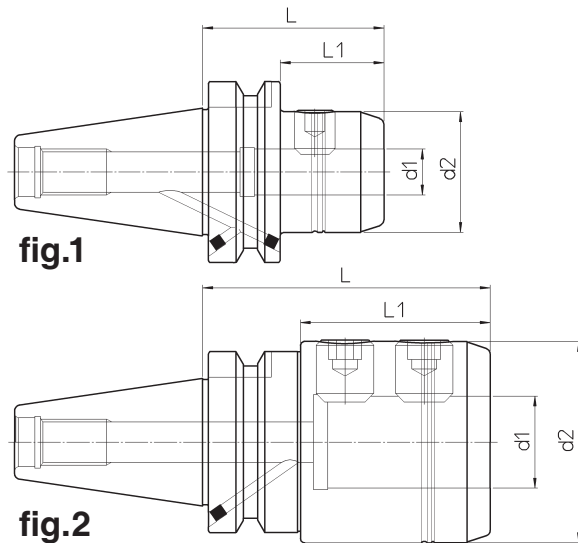

WD

BT	REF.	CODE	d ₁ H ⁵	d ₂	L	L ₁	kg	fig.
50	MAS403 BT50-AD+B WD06.63	71MBT-B50WD0606	6	23	63	25	2.3	1
	MAS403 BT50-AD+B WD06.110	71MBT-B50WD0611			110	72	2.4	
	MAS403 BT50-AD+B WD06.160	71MBT-B50WD0616			160	122	2.6	
	MAS403 BT50-AD+B WD08.63	71MBT-B50WD0806	8	26	63	25	2.4	
	MAS403 BT50-AD+B WD08.110	71MBT-B50WD0811			110	72	2.5	
	MAS403 BT50-AD+B WD08.160	71MBT-B50WD0816			160	122	2.7	
	MAS403 BT50-AD+B WD10.70	71MBT-B50WD1007	10	30	70	32	3	
	MAS403 BT50-AD+B WD10.110	71MBT-B50WD1011			110	72	3.2	
	MAS403 BT50-AD+B WD10.160	71MBT-B50WD1016			160	122	3.4	
	MAS403 BT50-AD+B WD12.70	71MBT-B50WD1207	12	34	70	32	3.1	
	MAS403 BT50-AD+B WD12.110	71MBT-B50WD1211			110	72	3.3	
	MAS403 BT50-AD+B WD12.160	71MBT-B50WD1216			160	122	3.6	
	MAS403 BT50-AD+B WD14.70	71MBT-B50WD1407	14	38	70	32	3.2	
	MAS403 BT50-AD+B WD14.110	71MBT-B50WD1411			110	72	3.5	
	MAS403 BT50-AD+B WD16.80	71MBT-B50WD1608	16	42	80	42	3.3	
	MAS403 BT50-AD+B WD16.110	71MBT-B50WD1611			110	72	3.5	
	MAS403 BT50-AD+B WD16.160	71MBT-B50WD1616			160	122	4	
	MAS403 BT50-AD+B WD18.80	71MBT-B50WD1808	18	46	80	42	3.4	
	MAS403 BT50-AD+B WD18.110	71MBT-B50WD1811			110	72	3.7	
	MAS403 BT50-AD+B WD20.80	71MBT-B50WD2008	20	50	80	42	3.5	
	MAS403 BT50-AD+B WD20.110	71MBT-B50WD2011			110	72	3.8	
	MAS403 BT50-AD+B WD20.160	71MBT-B50WD2016			160	122	4.5	
	MAS403 BT50-AD+B WD25.100	71MBT-B50WD2510	25	63	100	62	4.5	
	MAS403 BT50-AD+B WD25.125	71MBT-B50WD2512			125	87	5	
MAS403 BT50-AD+B WD25.160	71MBT-B50WD2516	160			122	5.7		
MAS403 BT50-AD+B WD32.100	71MBT-B50WD3210	32	70	100	62	5.6		
MAS403 BT50-AD+B WD32.160	71MBT-B50WD3216			160	122	7		
MAS403 BT50-AD+B WD40.110	71MBT-B50WD4011	40	80	110	72	5.8		
MAS403 BT50-AD+B WD40.160	71MBT-B50WD4016			160	122	7.4		

p. 228

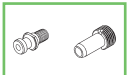

p. 240



p. 271



Mill holder

Werkzeugaufnahme
für Aufsteckfräser

Оправки для насадных
фрез

Wyjście pod głowice
frezarskie

Portafresa

PF

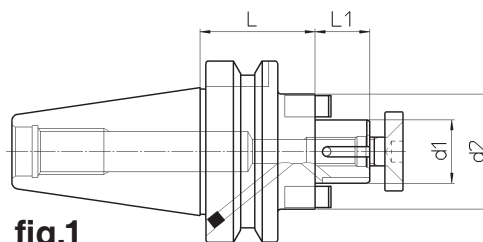
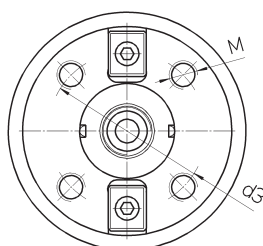

fig.1

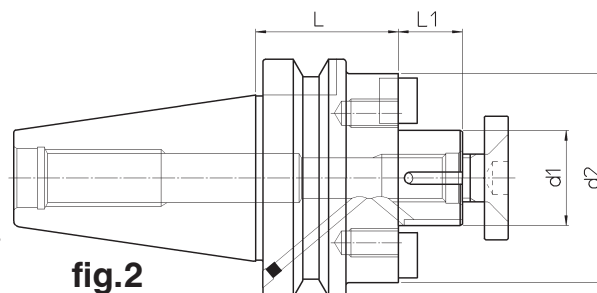

fig.2

BT	REF.	CODE	d ₁	d ₂	d ₃	M	L	L ₁	kg	fig.		
40	MAS403 BT40-AD+B PF16.40	71MBT-B40PF1604	16	32	-	-	40	-	0.9	1		
	MAS403 BT40-AD+B PF16.110	71MBT-B40PF1611					110				17	1.3
	MAS403 BT40-AD+B PF16.160	71MBT-B40PF1616					160				1.6	
	MAS403 BT40-AD+B PF22.40	71MBT-B40PF2204	22	40			40				1	
	MAS403 BT40-AD+B PF22.110	71MBT-B40PF2211					110				19	1.6
	MAS403 BT40-AD+B PF22.160	71MBT-B40PF2216					160				2.1	
	MAS403 BT40-AD+B PF27.45	71MBT-B40PF2704	27	50			45				1.2	
	MAS403 BT40-AD+B PF27.110	71MBT-B40PF2711					110				21	2.2
	MAS403 BT40-AD+B PF27.160	71MBT-B40PF2716					160				2.9	
	MAS403 BT40-AD+B PF32.50	71MBT-B40PF3205	32	60			50				1.7	
	MAS403 BT40-AD+B PF32.110	71MBT-B40PF3211					110				24	3
MAS403 BT40-AD+B PF40.55	71MBT-B40PF4005	40	70	55	27	2.1						
50	MAS403 BT50-AD+B PF16.50	71MBT-B50PF1605	16	32	50	2.4						
	MAS403 BT50-AD+B PF16.110	71MBT-B50PF1611			110	17	2.8					
	MAS403 BT50-AD+B PF16.160	71MBT-B50PF1616			160	3.1						
	MAS403 BT50-AD+B PF22.50	71MBT-B50PF2205	22	40	50	2.6						
	MAS403 BT50-AD+B PF22.110	71MBT-B50PF2211			110	19	3.2					
	MAS403 BT50-AD+B PF22.160	71MBT-B50PF2216			160	3.7						
	MAS403 BT50-AD+B PF27.55	71MBT-B50PF2705	27	50	55	2.7						
	MAS403 BT50-AD+B PF27.110	71MBT-B50PF2711			110	21	3.6					
	MAS403 BT50-AD+B PF27.160	71MBT-B50PF2716			160	4.3						
	MAS403 BT50-AD+B PF32.55	71MBT-B50PF3205	32	60	55	3.2						
	MAS403 BT50-AD+B PF32.120	71MBT-B50PF3212			120	24	5.5					
	MAS403 BT50-AD+B PF40.60	71MBT-B50PF4006	40	88	66.7	M12	60	27	4.3			
	MAS403 BT50-AD+B PF40.120	71MBT-B50PF4012					120	7.1	2			
MAS403 BT50-AD+B PF60.80	71MBT-B50PF6008	60	128.5	101.6	M16	80	40	6.8				

p. 271

p. 240

p. 228

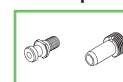

MAS 403 BT AD+B

CM - DIN 228 AB



Morse taper
toolholder

Werkzeugaufnahme
für Morsekegel

Державки для
инструмента
с конусом Морзе

Wyjście pod stożki
Morse'a

Portautensile cono
morse

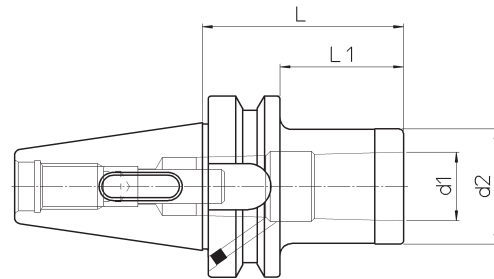

CM

BT	REF.	CODE	MORSE	d ₁	d ₂	L	L ₁	kg
40	MAS403 BT40-AD+B CM2.50 A-B	71MBT-B40CMB205	2	17.780	32	50	23	1
	MAS403 BT40-AD+B CM2.125 A-B	71MBT-B40CMB212				125	98	1.3
	MAS403 BT40-AD+B CM3.70 A-B	71MBT-B40CMB307	3	23.825	40	70	43	1.1
	MAS403 BT40-AD+B CM3.140 A-B	71MBT-B40CMB314				140	113	1.5
50	MAS403 BT50-AD+B CM2.60 A-B	71MBT-B50CMB206	2	17.780	32	60	22	2.6
	MAS403 BT50-AD+B CM2.125 A-B	71MBT-B50CMB212				125	87	2.8
	MAS403 BT50-AD+B CM3.60 A-B	71MBT-B50CMB306	3	23.825	40	60	22	2.7
	MAS403 BT50-AD+B CM3.145 A-B	71MBT-B50CMB314				145	107	3.2
	MAS403 BT50-AD+B CM4.80 A-B	71MBT-B50CMB408	4	31.267	48	80	42	2.9

MAS 403 BT

MS

Tapping toolholder

Aufnahme mit
Gewindeschneidschnellwechselfutter

Патроны
резьбонарезные

Oprawki do gwintowania
z kompensacją osiową

Portautensile
maschiatore

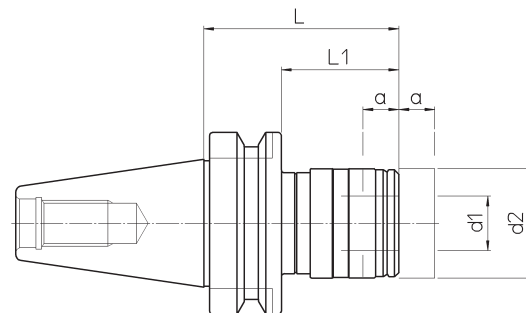

MS

BT	REF.	CODE	d ₁	d ₂	L	L ₁	a	kg
40	MAS403 BT40 MS1 M3-12	71MBT-40-M10312	19	36	67.5	40.5	7.5	0.9
	MAS403 BT40 MS2 M8-20	71MBT-40-M20820	31	53	94.5	67.5	12.5	1.3
50	MAS403 BT50 MS1 M3-12	71MBT-50-M10312	19	38	80	42	7.5	2.8
	MAS403 BT50 MS2 M8-20	71MBT-50-M20820	31	53	102.5	64.5	12.5	3.1
	MAS403 BT50 MS3 M14-33	71MBT-50-M31433	48	78	154.5	116.5	20	4.3

p. 228

p. 234-235

p. 271

